

REVISIONS			
REV.	DESCRIPTION	DATE	APPROVED
A	INITIAL RELEASE	7/08/09	GMK

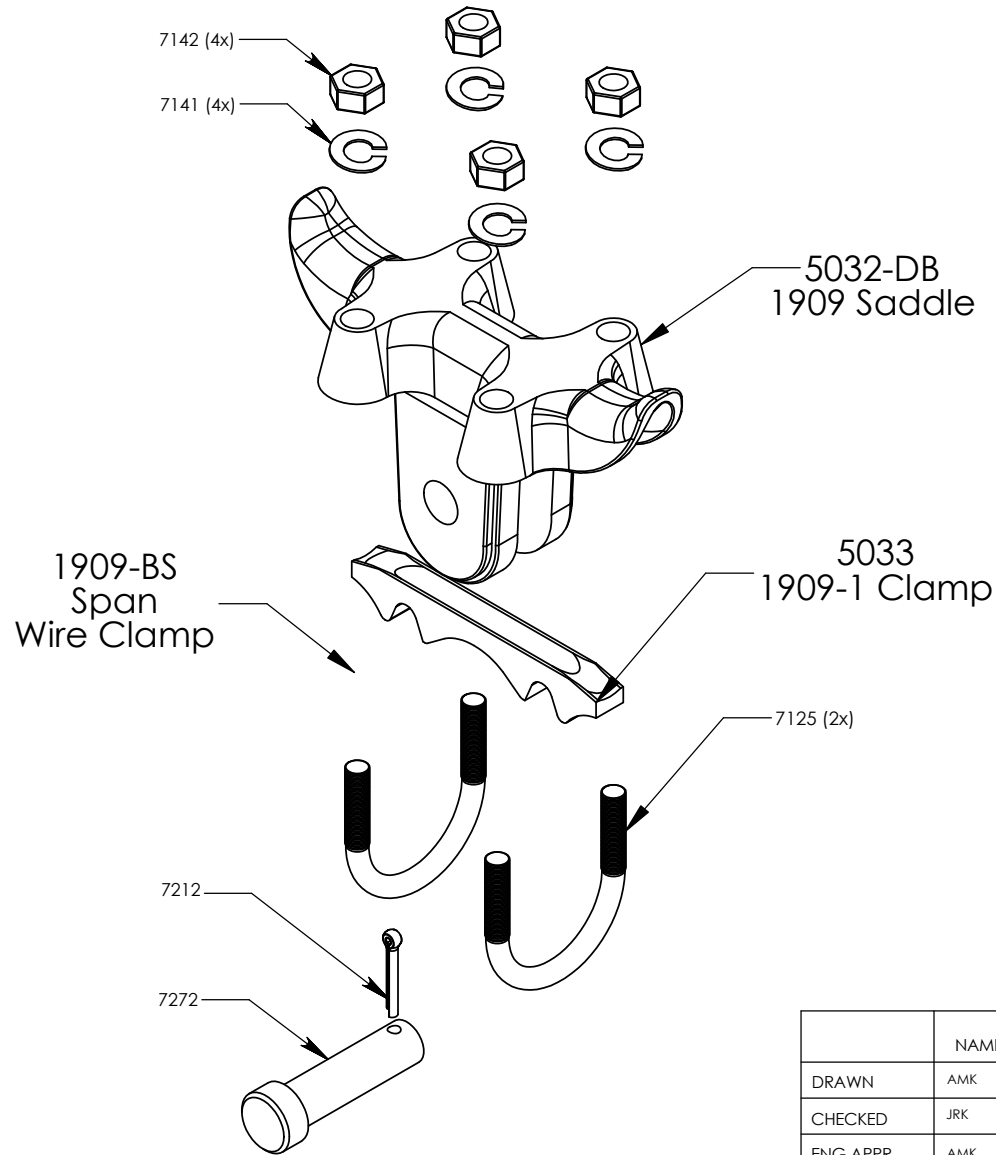

ITEM NO.	PART DESCRIPTION	
1909-BS	1909 Span Wire Clamp, SS304 Bushings/Pin	
5032-DB	1909 Span Wire Saddle, Al Alloy 535.0, SS304 Bushings (2)	1
5033	1909-1 Clamp, Al Alloy 535.0	1
7125	3/8"-16 x 1-3/16" U-Bolt, SS304	2
7141	3/8" Washer, Lock, SS304	4
7142	3/8"-16 Nut, SS304	4
7272	5/8" Clevis Pin (Rivet), Hot Dip Galvanized	1
7212	Cotter Pin, SS304	

	NAME	DATE
DRAWN	AMK	12/10/09
CHECKED	JRK	12/10/09
ENG APPR.	AMK	12/10/09
MFG APPR.	GMK	12/10/09

PROPRIETARY AND CONFIDENTIAL
 THE INFORMATION CONTAINED IN THIS DRAWING IS THE SOLE PROPERTY OF COST CAST, INC. ANY REPRODUCTION IN PART OR AS A WHOLE WITHOUT THE WRITTEN PERMISSION OF COST CAST, INC. IS PROHIBITED.

UNLESS OTHERWISE SPECIFIED:
 DIMENSIONS ARE IN INCHES
 TOLERANCES:
 ANGULAR: MACH ± 1/32"
 TWO PLACE DECIMAL ± .03"
 THREE PLACE DECIMAL ± .010"
 INTERPRET GEOMETRIC TOLERANCING PER:
 MATERIAL: VARIOUS
 FINISH: VARIOUS
 DO NOT SCALE DRAWING

COST CAST, INC

TITLE:
1909-BG
 Span Wire Clamp Assembly

SIZE A	DWG. NO. 13724	REV A
SCALE: 1:16	WEIGHT:	SHEET 1 OF 1