

REVISIONS

REV.	DESCRIPTION	DATE
A	INITIAL RELEASE	10/28/15

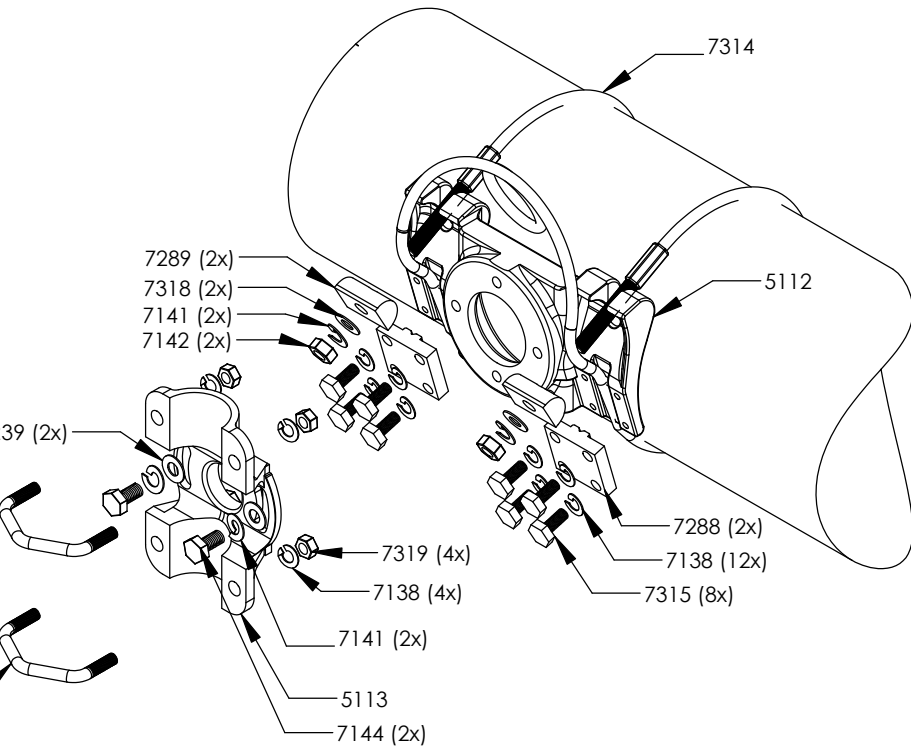

ITEM NO.	PART DESCRIPTION
1416-A-C120D	1416 Saddle & Swivel Assembly, 120" Cable Dou Swage, SS
5112	1416 Mast Arm Bracket Saddle, Al Alloy 535.0
5113	1416 Mast Arm Bracket Swivel, Al Alloy 535.0
7314	Aircraft Cable, 120" Long, Double 3/8" Swage
7315	5/16"-18 x 3/4" Cap Screw, SS304
7138	5/16" Washer, Lock, SS304
7288	Clamp, Cable, Four-Bolt, Extruded, Al,
7289	Wedge, Aluminum, Extruded, 1316/1346 & 1416/1446
7318	3/8" Washer, Fender, Flat, SS304
7316	V-Bolt: 5/16"-18, SS304
7319	5/16"-18, Hex Nut
7144	3/8"-16 x 1-1/4" Cap Screw, SS304
7141	3/8" Washer, Lock, SS304

	NAME	DATE	UNLESS OTHERWISE SPECIFIED: DIMENSIONS ARE IN INCHES TOLERANCES: ANGULAR: MACH ± 1/32" TWO PLACE DECIMAL ± .03" THREE PLACE DECIMAL ± .010"	COST CAST, IN TITLE: 1416-A-C120 Value-Brac, Mast-Arm 120" SS Cable, Stainless Steel Hard
DRAWN	H.ER. B	10/20/14		
CHECKED	SAM	10/21/14		
ENG APPR.	JRK	10/22/14		
MFG APPR.	AMK	10/25/14	INTERPRET GEOMETRIC TOLERANCING PER:	SIZE DWG. NO. A 13871
PROPRIETARY AND CONFIDENTIAL THE INFORMATION CONTAINED IN THIS DRAWING IS THE SOLE PROPERTY OF COST CAST, INC. ANY REPRODUCTION IN PART OR AS A WHOLE WITHOUT THE WRITTEN PERMISSION OF COST CAST, INC. IS PROHIBITED.			MATERIAL VARIOUS	
			FINISH VARIOUS	SCALE: 1:16 WEIGHT:
			DO NOT SCALE DRAWING	

5 4 3 2 1