

REVISIONS			
REV.	DESCRIPTION	DATE	APPROVED
A	INITIAL RELEASE	05/04/2016	AMK

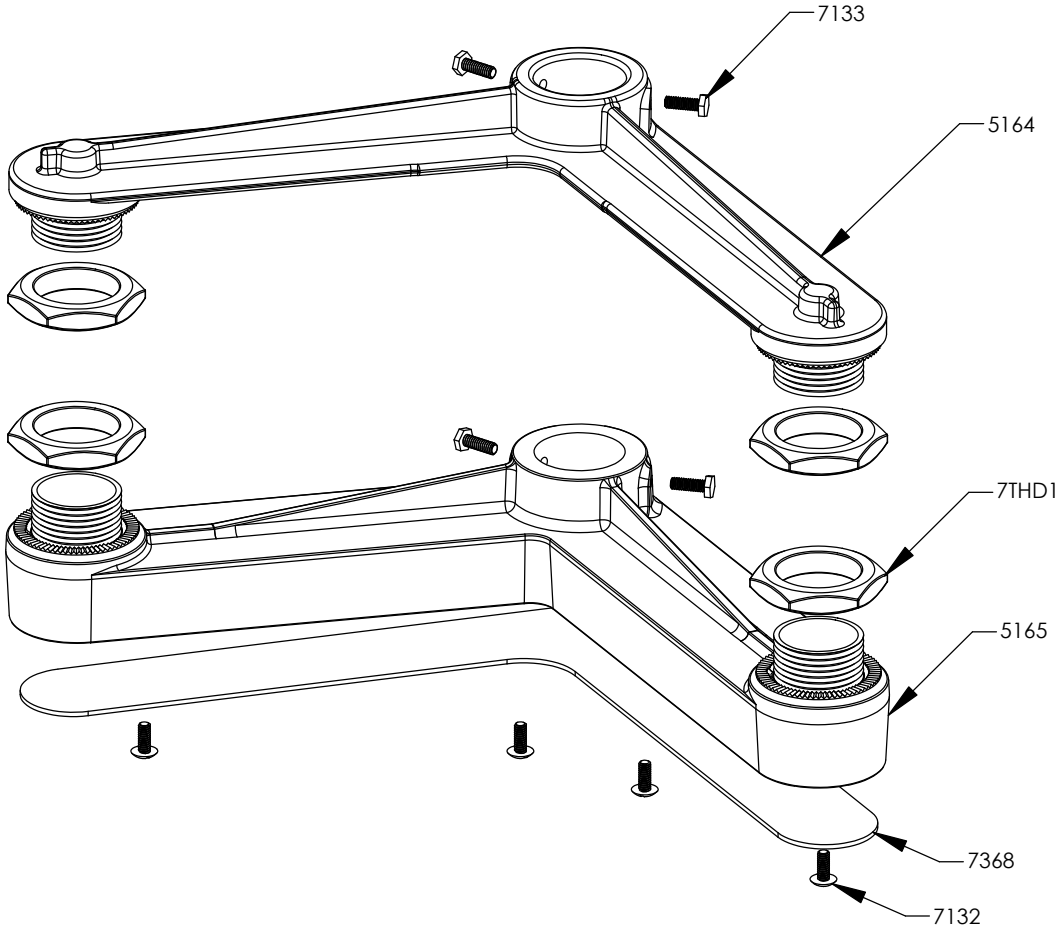

ITEM NO.	PART DESCRIPTION	
5164	1946 2-Way TACL Top, Coupling	1
5165	1946 2-Way TACL Bottom, Coupling	1
7368	TACL Bottom Arm Cover, Plastic	1
7133	1/4"-20x 3/4" Cap Screw, Hex Head, SS304	4
7132	1/4"-20x 3/4" Cap Screw, Truss Head, SS304	4
7THD1	1 1/2" NPS Hex Nut	4

			UNLESS OTHERWISE SPECIFIED:			COST CAST, INC		
DRAWN	ACW	05/02/2016	DIMENSIONS ARE IN INCHES TOLERANCES: FRACTIONAL ± ANGULAR: MACH ± 1/32" TWO PLACE DECIMAL ± .03" THREE PLACE DECIMAL ± .010"	TITLE: 1942 2-Way Tube Arm Cluster (TACL) Assembly, 1 1/2" NPS Coupling Attachment				
CHECKED	HERB	05/02/2016						
ENG APPR.	BRD	05/02/2016						
MFG APPR.	IST	05/02/2016						
Q.A.	WRD	05/02/2016						
PROPRIETARY AND CONFIDENTIAL THE INFORMATION CONTAINED IN THIS DRAWING IS THE SOLE PROPERTY OF COST CAST, INC. ANY REPRODUCTION IN PART OR AS A WHOLE WITHOUT THE WRITTEN PERMISSION OF COST CAST, INC. IS PROHIBITED.			INTERPRET GEOMETRIC TOLERANCING PER:	SIZE A		DWG. NO. 13841		REV A
			MATERIAL VARIOUS	SCALE: 1:10		WEIGHT:		SHEET 1 OF 1
			FINISH VARIOUS					
			DO NOT SCALE DRAWING					

5

4

3

2

1

D

C

B

A