

REVISIONS			
REV.	DESCRIPTION	DATE	APPROVED
A	INITIAL RELEASE	4/5/12	AMK

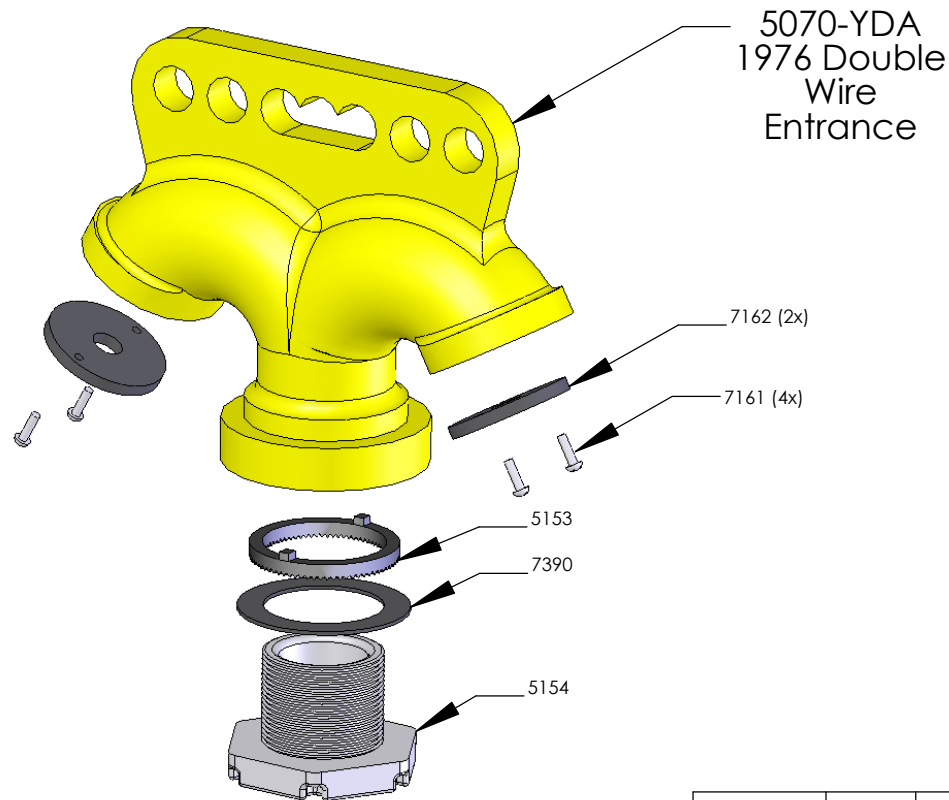

ITEM NO.	PART DESCRIPTION	
5070-YDA	Double Wire Entrance, Multi-Eye Top, Tri-Stud Base, Yellow, Al Alloy 319.0, Cast in 5/16"-18 SS304 Studs (3)	1
7162	Grommet, For 1976, Rubber	2
7161	6-32 x 1/2" Thread Cutting Screw, SS304	4
7801-3	Washer Kit, Tri-Stud	1
5153	Wingle Serrated Washer, Two Tab	1
5154	Hex Nipple, Treaded, 1 1/2" NPS, 1 1/2" Long	1
7390	Rubber Gasket	1

	NAME	DATE	UNLESS OTHERWISE SPECIFIED:		
DRAWN	H. E. RB	4/7/09	DIMENSIONS ARE IN INCHES TOLERANCES: ANGULAR: MACH ± 1/32" TWO PLACE DECIMAL ± .03" THREE PLACE DECIMAL ± .010"		
CHECKED			INTERPRET GEOMETRIC TOLERANCING PER:		
ENG APPR.	AMK	4/7/09	MATERIAL VARIOUS		
MFG APPR.			FINISH VARIOUS		
PROPRIETARY AND CONFIDENTIAL THE INFORMATION CONTAINED IN THIS DRAWING IS THE SOLE PROPERTY OF COST CAST, INC. ANY REPRODUCTION IN PART OR AS A WHOLE WITHOUT THE WRITTEN PERMISSION OF COST CAST, INC. IS PROHIBITED.			COST CAST, INC TITLE: 1976-D-SCC Double Wire Entrance Fitting, Multi-Eye Top, Coupling Base, Yellow		
			DWG. NO. 13774		SHEET 1 OF 1